

ALI4251

This line includes all “the truss clamps” designed for tubes from 42 to 51 mm. Truss clamps are all supplied with M12 wing nuts.



HCL5111F

ALI4251 FLAT
SWL 780 kg

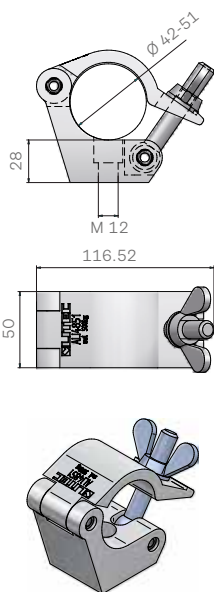

HCL5102F

ALI4251 FL M12/35
SWL 780 kg

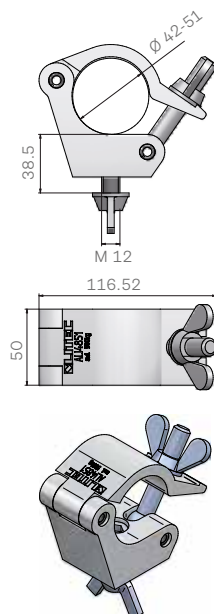

HCL51L01F

ALI4251 FL. 1/2 SP.
SWL 780 kg

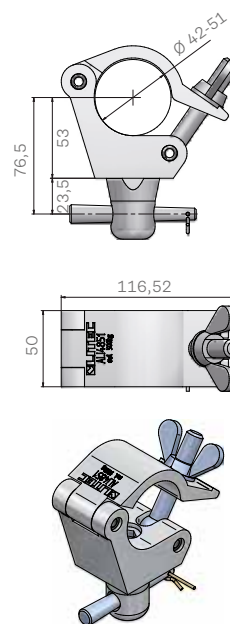

ALI4251N

This line includes all “the NARROW truss clamps” designed for tubes from 42 to 51 mm. Truss clamps are all supplied with M12 wing nuts.



HCL5112FN

ALI4251 FLAT N
SWL 410 kg

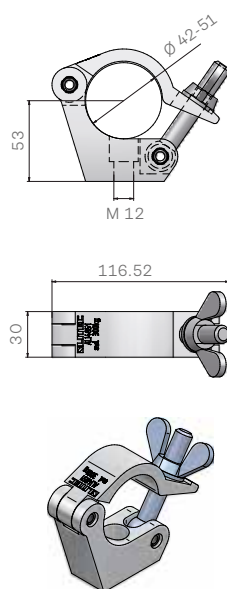

HCL5102FN

ALI4251 FL. N. M12/35
SWL 410 kg

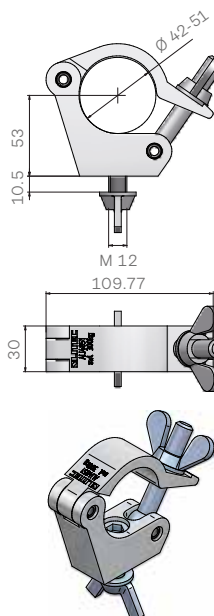

HCL51L01FN

ALI4251 FL. N. 1/2 SP.
SWL 410 kg

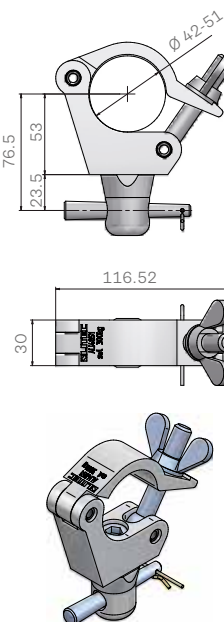

ALI4851

This line includes all “the truss clamps” designed for tubes from 48 to 51 mm. Truss clamps are all supplied with M12 wing nuts.



HCL5101

ALI4851
SWL 650 kg

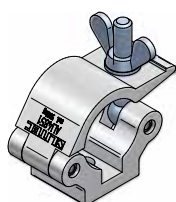
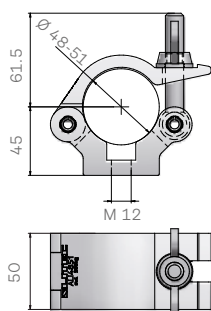

HCL5102

ALI4851 M12/35
SWL 650 kg

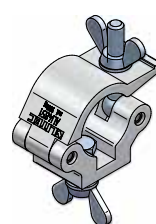
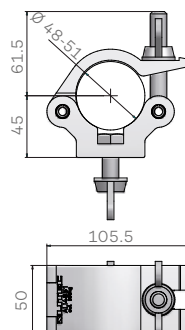

HCL51L01

ALI4851 1/2 SPIGOT
SWL 650 kg

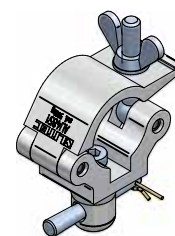
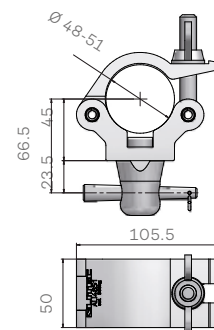

HCL51L02

ALI4851 FORK ADJ
SWL 650 kg

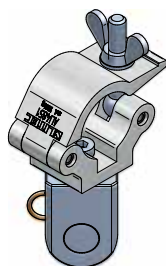
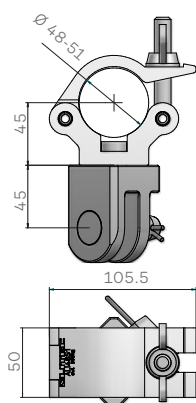

HCL51L03

ALI4851 FORK FIXED
SWL 650 kg

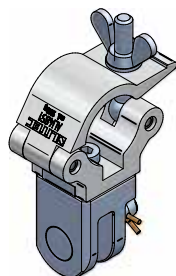
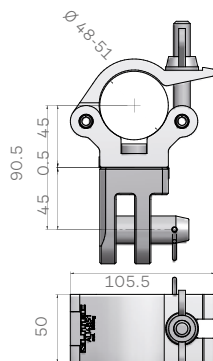

HCL5103W050

ALI4851 LIFT.EYE
SWL 650 kg

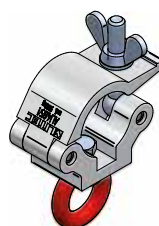
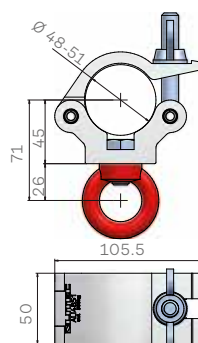

HCL5104

ALI4851 SWIVEL
SWL 540 kg

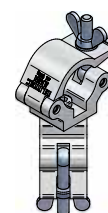
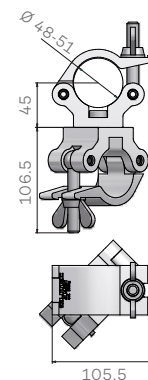

HCL5105

ALI4851 90° FIXED
SWL 540 kg

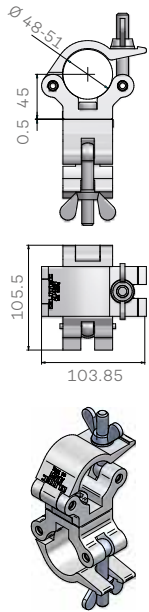

HCL5106

ALI4851 PARALLEL
SWL 540 kg

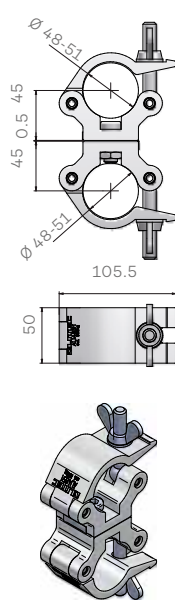

HCL516304

ALI4851-ALI6063
SWIVEL SWL 540 kg

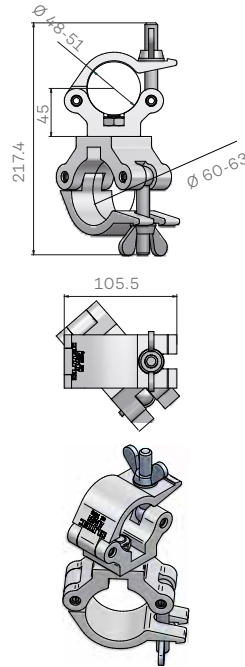

HCL516305

ALI4851-ALI6063
90° FIXED SWL 540 kg

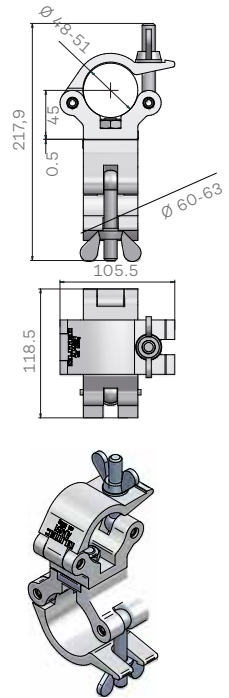

HCL516306

ALI4851-ALI6063
PARALLEL SWL 540 kg

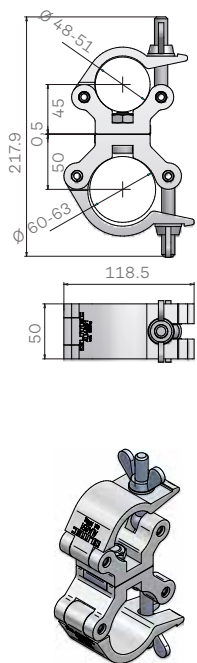

HCL51L07

ALI4851 28 SP.
Truss Support 25-30

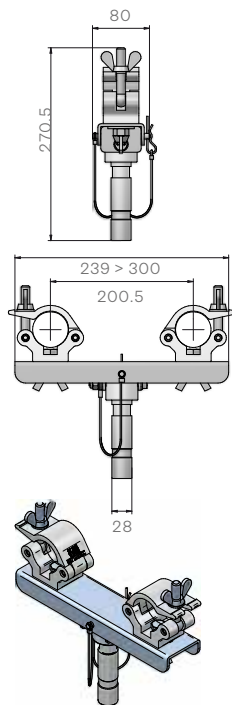

HCL51L08

ALI4851 28 SP.
Truss Support 30-40

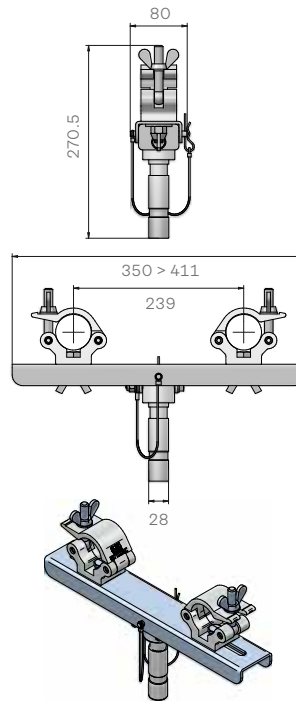

HCL51PC

ALI4851 Panel clamp for easy clamping (5 mm - 8 mm)

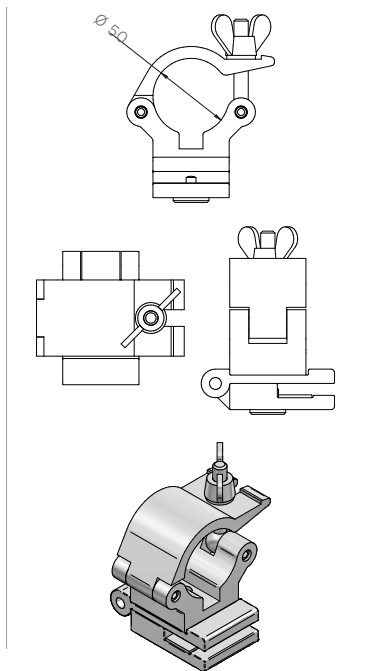

HCL51CL

ALI4851 Clamp for cladding of the entire structure

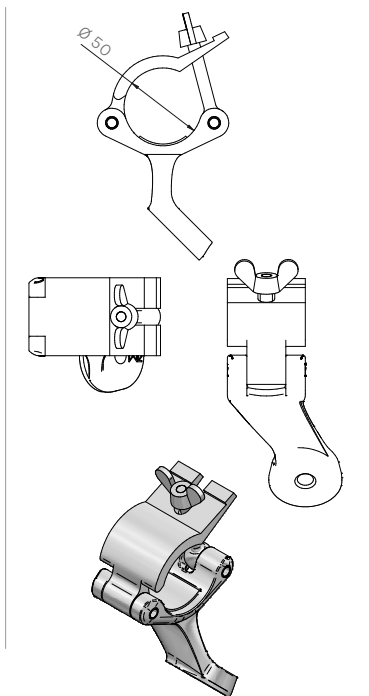

HCL51CL

applications



ALI4851N

This line includes all “the NARROW truss clamps” designed for tubes from 48 to 51 mm. Truss clamps are all supplied with M12 wing nuts.



HCL5107N

ALI4851 NARROW
SWL 560 kg

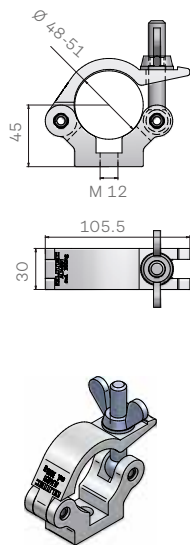

HCL5108N

ALI4851 N. M12/50
SWL 560 kg

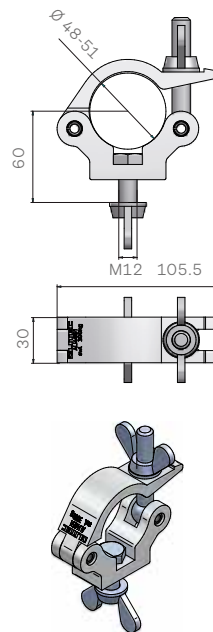

HCL51L01N

ALI4851 N. 1/2 SP.
SWL 560 kg

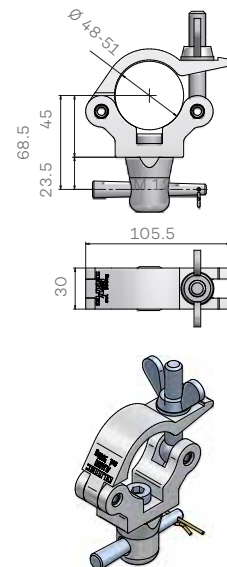

HCL51L02N

ALI4851 N. FORK ADJ.
SWL 560 kg

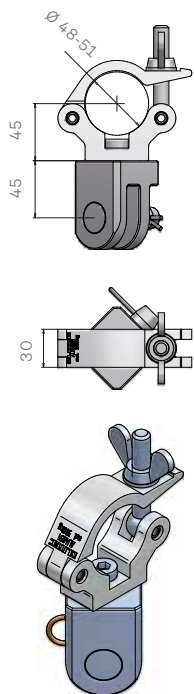

HCL51L03N

Truss clamp ALI4851 N.
FORK FIXED SWL 560 kg

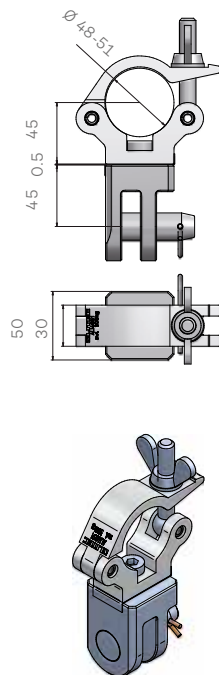

HCL5103W030N

ALI4851 LIFT. EYE
SWL 300 kg

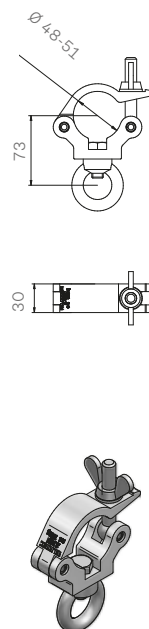

HCL5104N

ALI4851 SWIVEL
SWL 540 kg

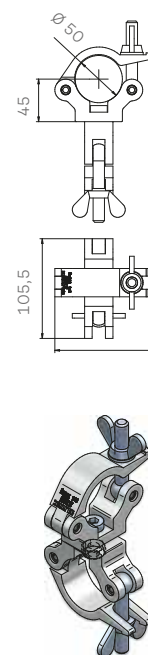

ALI4851S

This line includes all “the SLIM truss clamps” designed for tubes from 48 to 51 mm. Truss clamps are all supplied with M10 wing nuts.



HCL5101S

ALI4851
SL. SWL 230 kg

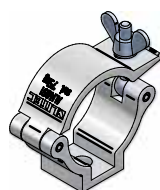
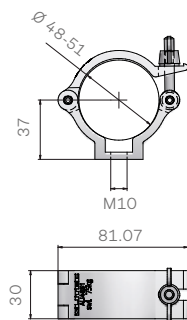

HCL5102S

ALI4851 SL. M10/30
SWL 230 kg

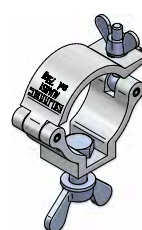
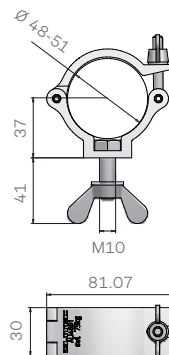

HCL51L01S

ALI4851 SL. 1/2 SP.
SWL 230 kg

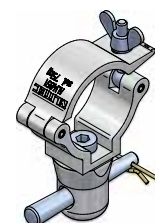
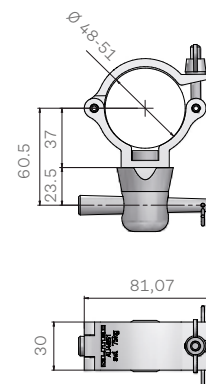

HCL5111S

ALI4851 SL. P.H.
SWL 230 kg

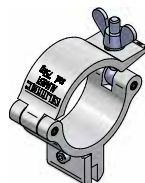
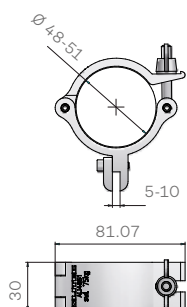

HCL5104S

ALI4851 SL. SW.
SWL 230 kg

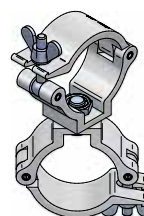
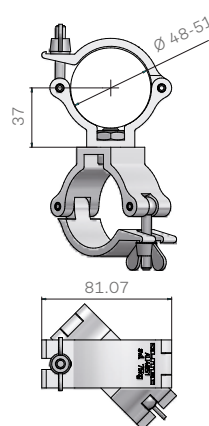

ALI6063

This line includes all “the truss clamps” designed for tubes from 60 to 63.5 mm. Truss clamps are all supplied with M12 wing nuts.



HCL6301

ALI6063
SWL 650 kg

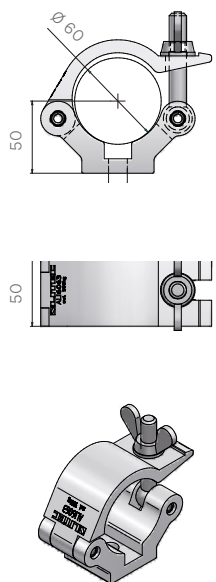

HCL6302

Truss clamp ALI6063
M12/35 SWL 650 kg

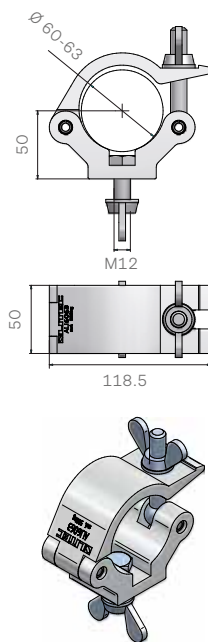

HCL6303W034

Truss clamp ALI6063
LIFT. EYE SWL 340 kg

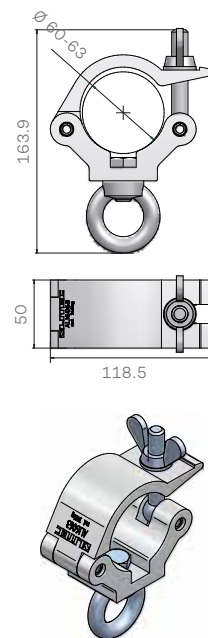

HCL63L01

Truss clamp ALI6063
1/2 SPIGOT SWL 650 kg

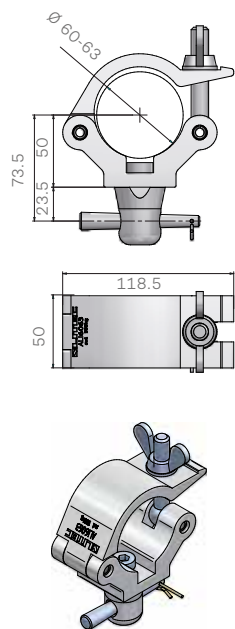

HCL63L02

Truss clamp ALI6063
FORK ADJ. SWL 650 kg

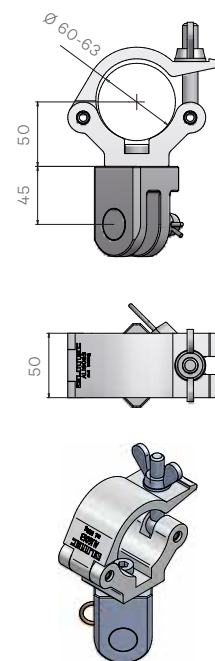

HCL63L03

Truss clamp ALI6063
FORK FIXED SWL 650 kg

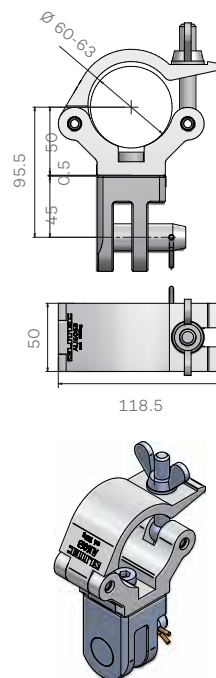

HCL6303W050

Truss clamp ALI6063
LIFT. EYE SWL 650 kg

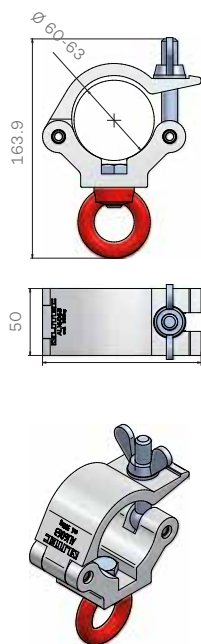

HCL6304

Truss clamp ALI6063
SWIVEL SWL 650 kg

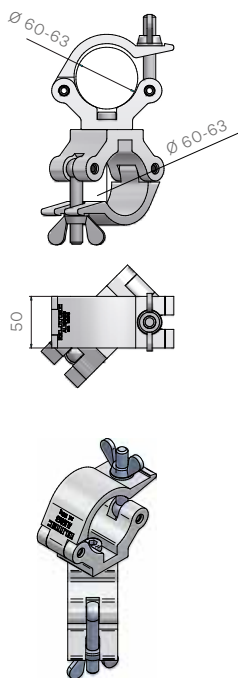

HCL6305

ALI6063 90° FIXED
SWL 650 kg

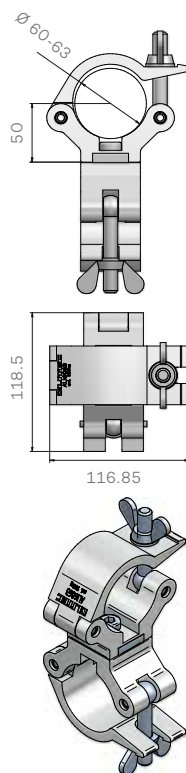

HCL6306

ALI6063 PARALLEL
SWL 650 kg

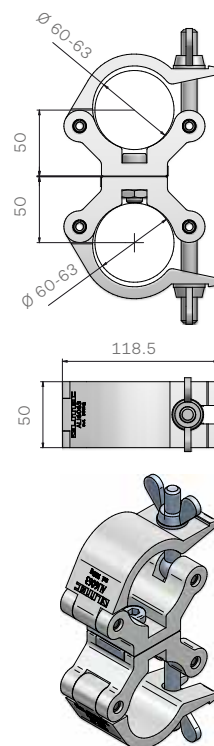

LIC3851

LIC3851 identifies a clamping range of products. This line includes all “the lighting clamps” to hang luminaires onto trusses with tubes with a diameter from 38 to 51 mm. Lighting clamps are all supplied with M12 wing nuts.



ACL51010

Truss clamp LIC3851
OP. swl 360 kg

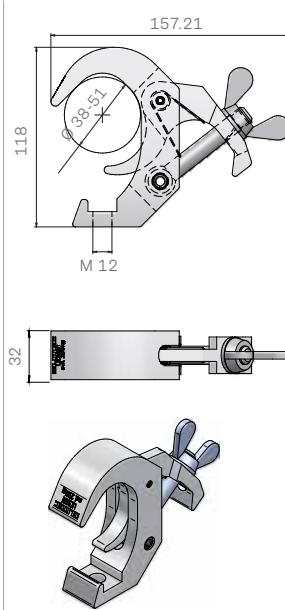

ACL51020

Truss clamp LIC3851
OP. M12/35 swl 360 kg

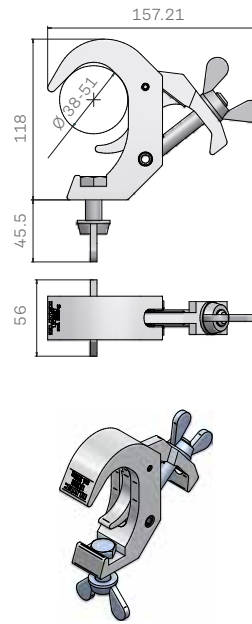

ACL51030

Truss clamp LIC3851
OP. LIFT. EYE swl 360 kg

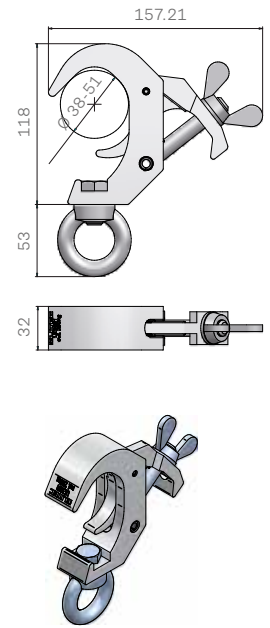

ACL51L040

Truss clamp LIC3851
OP. 28 BUSHING swl 360 kg

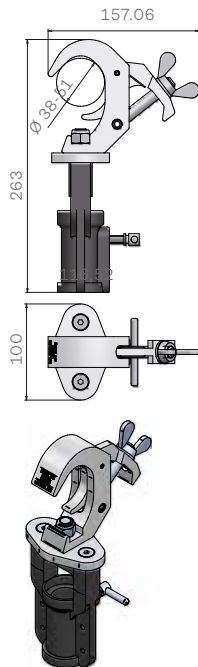

ACL51L050

Truss clamp LIC3851
OP. 28 SPIGOT swl 360 kg

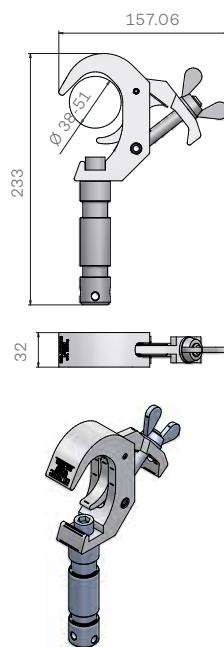

ACL51L060

Truss clamp LIC3851
OP. 16 SPIGOT swl 360 kg

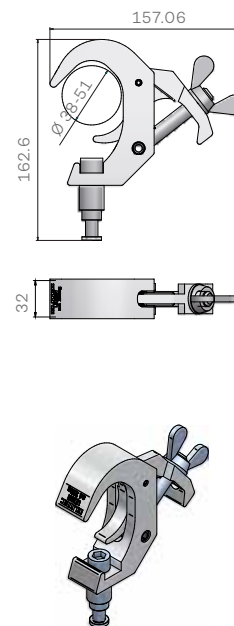

ACL51L100

Truss clamp LIC3851
OP. 16 - 28 BUS. swl 360 kg

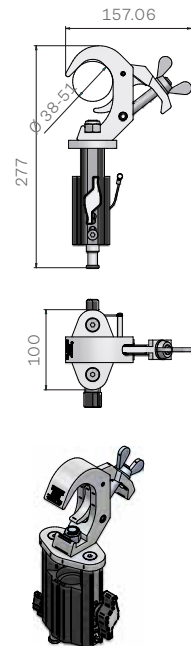

LIC4851

This line includes all “the lighting clamps” to hang luminaires onto trusses with tubes with a diameter from 48 to 51 mm. These lighting clamps are all supplied with knobs.



ACL5101C

Truss clamp LIC4851
CL. swl 350 kg

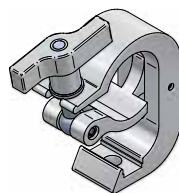
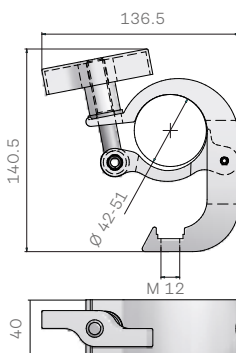

ACL5102C

Truss clamp LIC4851 CL.
M12/35 swl 350 kg

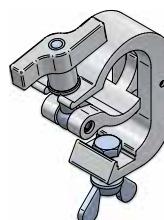
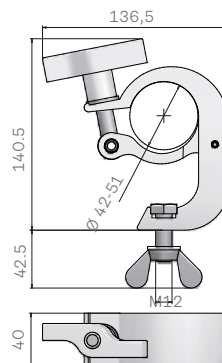

ACL5103C

Truss clamp LIC4851 CL.
LIFT. EYE swl 350 kg

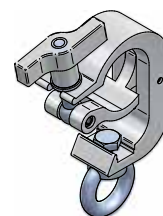
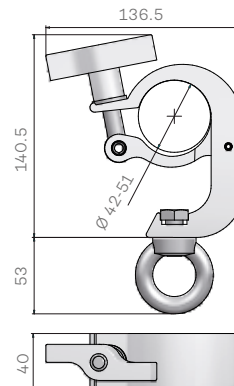

ACL51L04C

Truss clamp LIC4851
CL. 28 BUSHING swl
350 kg

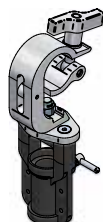
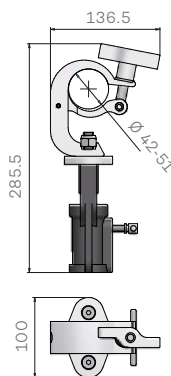

ALI51L05C

Truss clamp LIC4851
CL. 28 SPIGOT swl 350 kg

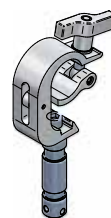
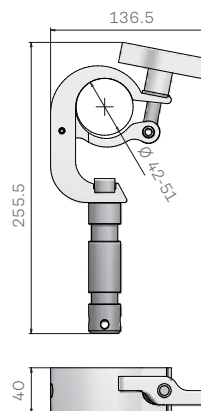

ACL51L10C

Truss clamp LIC4851
CL. 16 - 28 BUS. swl
350 kg

