

RL105A

21 x 16 m Double-pitch

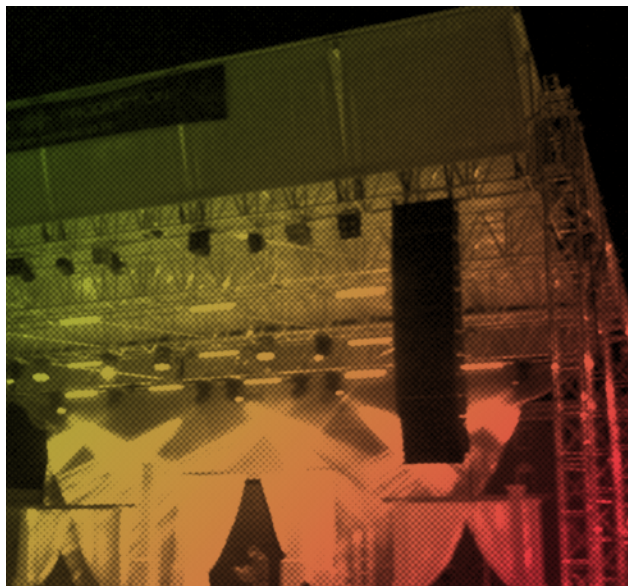

They are strong and sturdy roof systems totally built in RL105A trusses and Maxitowers 52.

They are thought for big installations on wide spans.

They feature new built-in guides for inserting roof sheets and a four-way sleeve block which is compatible with LIBERA FL105.

Dimensions		21 x 16 m
Heights range*	→	from 10 to 16 m
Main truss	→	RL105A
Towers	→	6 x Maxitower 52
Uniformly distributed load UDL **	→	20000 kg
Chain hoists	→	2000 kg
Total weight	→	13500 kg
Volume	→	160 m ³
Set-up time & number of workers	→	8 hrs / 6 w

* Range suggested according to the dimensions of the roof system.

** Indicative loading data for use in environments without wind. For details and further information, please consult the technical specifications or contact our engineering department or distributors.

For details and further information, please consult the technical specifications or contact our engineering department or distributors.

The examples and data shown on these pages are necessarily indicative owing to the extreme variability of the conditions in which the structures may be assembled. Each installation must be provided with a suitable quantity of ballast, as shown on the product certificates.

This line of structures was created in compliance with European standards. Use of these systems is governed by laws which vary according to the country they are assembled in. They must be put together in compliance with the local regulations in force.

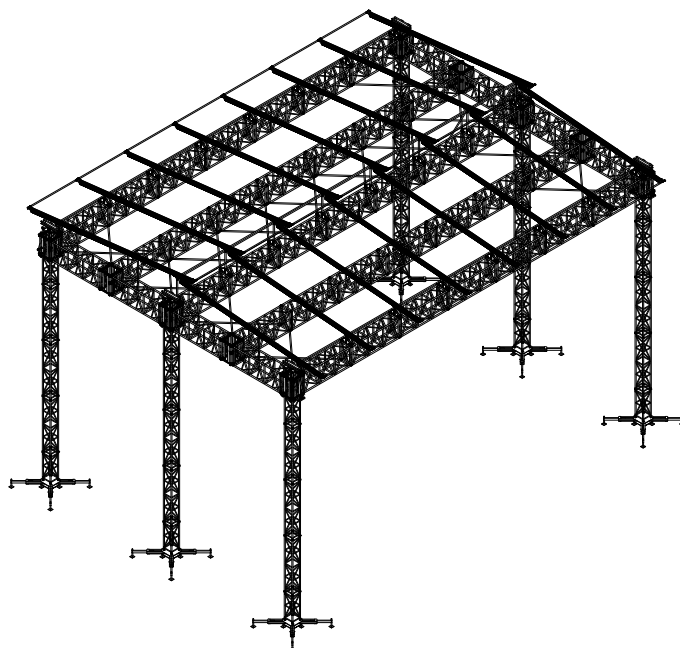

RL105A 21 x 16 m

Side extensions for suspensions outside the set may be added to the front.

